

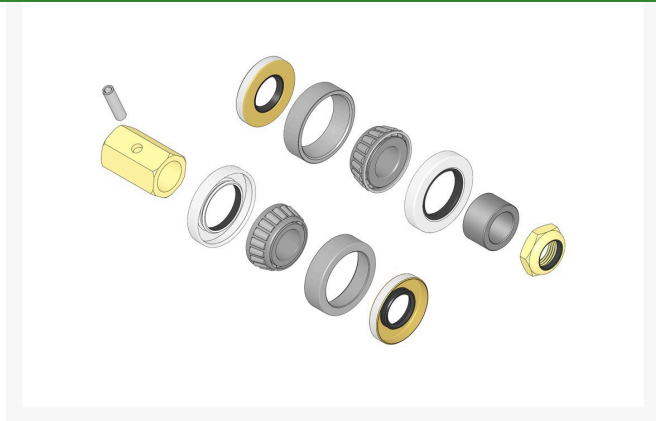

Overhaul Kit - Roller

R100185



Details

Includes 2 ea.: R253-117 Seals, R253-122 Seals, R254-78 Bearings, R254-79 Bearing Cups, R5-4038 Wear Sleeves; 1ea.: R32121-24 Roll Pin, R3296-15 Locknut, & R5-4040 Adjusting Nut

Specifications

Manufacturer R&R Products

Fits Models

Toro Super Pro

Replacement Parts

R253-117	Seal - Outer Triple Lip
R253-122	Seal
R254-78	Tapered Bearing Cone
R254-79	Cup - Bearing
R32121-24	Pin - Sp Roll 1/4 x 1
R3296-15	Locknut - 3/4-16 Nylon Jam
R5-4038	Sleeve - Wear Reel Shaft
R5-4040	Nut - Adjusting Roller

Baber Turf Equipment Co.

Unit 6 / 10 Firth Street Auckland, 2113

09 294 6040

<https://baber.rrproducts.com/>