

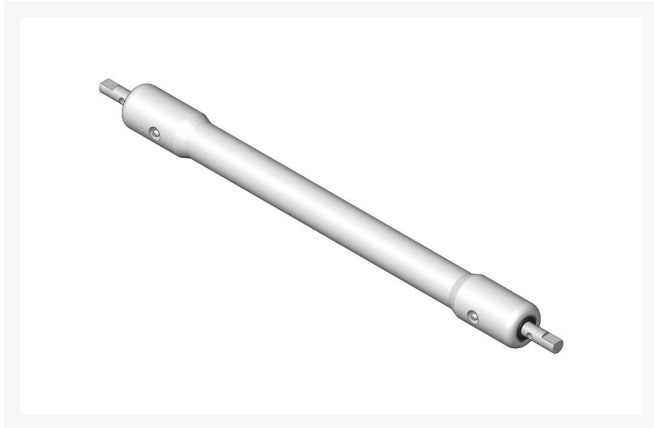

# Roller - Swaged Machined Aluminum

R101122



## Details

Constructed with "water-pump" style bearings, this steel tubular roller contacts the ground only on the outer 2-7/8" of the roller.

## Specifications

Manufacturer	R&R Products
Roller Body	2 in
Diameter	
Weight (lbs)	4 lb

## Fits Models

- Jacobsen Eclipse 122F
- Jacobsen E-Plex
- Jacobsen E-Plex II
- Jacobsen Greens King II
- Jacobsen Greens King IV
- Jacobsen Greens King V & VI
- Jacobsen G-Plex III
- Jacobsen PGM 19
- Jacobsen PGM 22

## Replacement Parts

R21-8430	Bearing - Roller
R302-5	Fitting - Grease

**Baber Turf Equipment Co.**

Unit 6 / 10 Firth Street Auckland, 2113  
09 294 6040

<https://baber.rrproducts.com/>