

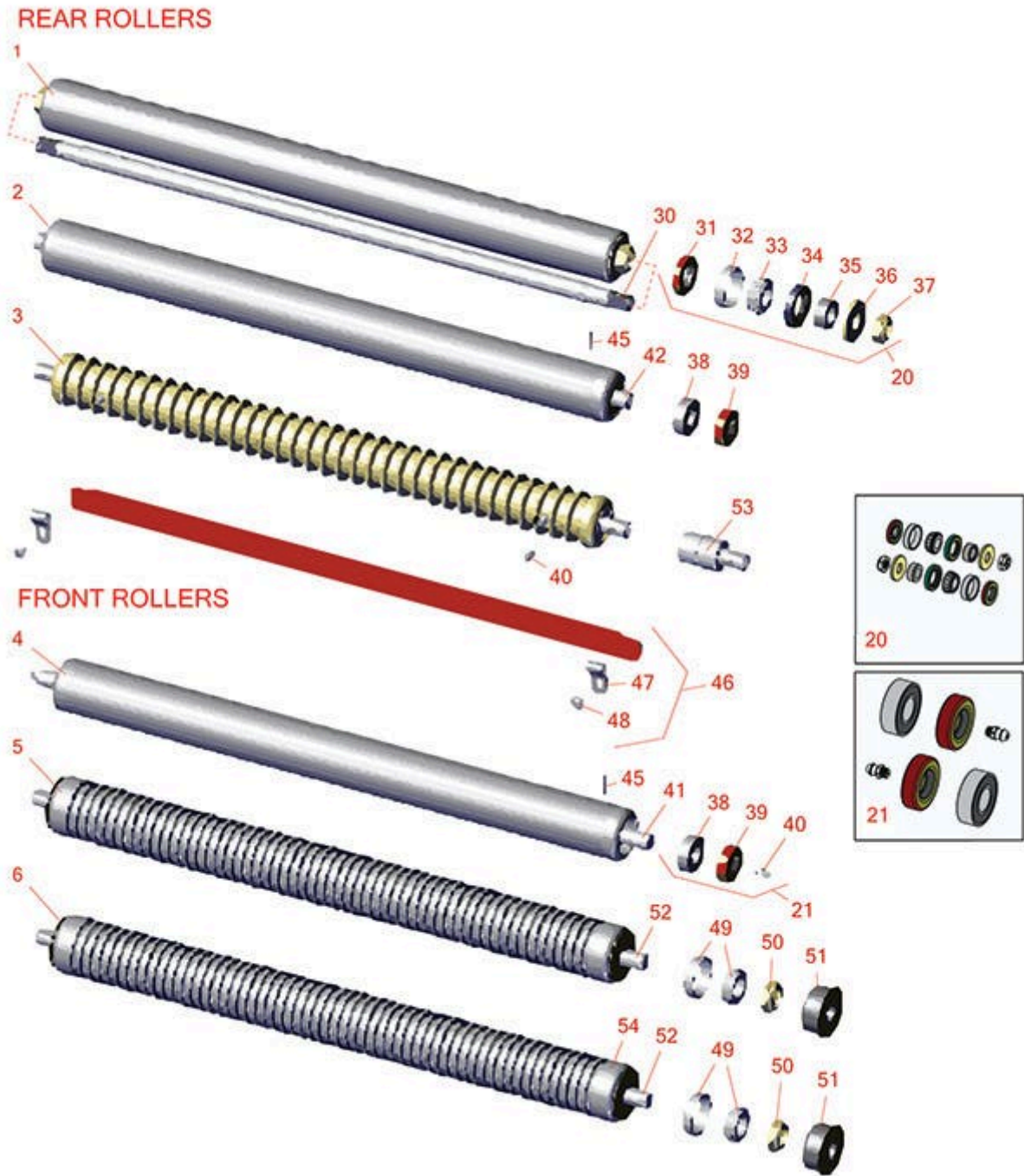

Replaces Jacobsen GP400 Parts

Cutting Unit
Rollers



All original equipment manufacturers names and part numbers are used for identification purposes only, and we are in no way implying that our products are original equipment parts. Prices subject to change without notice.



Replaces Jacobsen GP400 Parts

Cutting Unit
Rollers



Item No	R&R Part No.	OEM Part No.	Description	Qty Req	Order Quantity
---------	--------------	--------------	-------------	---------	----------------

R&R Rollers Available

1	R1000770	1000770	Roller - Smooth Heavy Duty Tubular Steel	1	
---	-----------------	---------	--	---	--

Tech Note: Constructed with a through shaft, this heavy-duty roller uses tapered bearings for extended life. Body length measures 23-1/4".:

2	R158777	1004990, 158777, 162916	Roller - Smooth Tubular Steel	1	
---	----------------	-------------------------------	-------------------------------	---	--

Tech Note: Constructed with a through shaft and greasable ball bearings.:

3	R101120	101120, 68580	Roller - Grooved Machined Solid Steel	1	
---	----------------	------------------	---------------------------------------	---	--

Tech Note: Machined from solid steel, this heavy weight roller uses greasable "water-pump" style bearings.:

4	R158776	158776, 162917	Roller - Smooth Tubular Steel	1	
---	----------------	-------------------	-------------------------------	---	--

Tech Note: Constructed with a through shaft and greasable ball bearings.:

5	R68613	68613	Roller - Grooved Repairable Steel	1	
---	---------------	-------	-----------------------------------	---	--

Tech Note: Machined from heavy wall steel tubing and a through shaft with greasable tapered bearings.:

6	R68614	68614	Roller - Grooved Machined Aluminum	1	
---	---------------	-------	------------------------------------	---	--

Overhaul Kits and Service Tools

20	R100139		Overhaul Kit - Roller	1	
----	----------------	--	-----------------------	---	--

Tech Note: Includes 2 ea.: R254-67 Bearing Cups, R254-68 Bearing Cones, R337593 Seals, R253-152 Seals R3001762 Wear Sleeves, R3000698 Washers & R445718 Locknuts:

21	R100130	100130	Overhaul Kit - Roller	1	
----	----------------	--------	-----------------------	---	--

Tech Note: Includes 2 ea.: R302-5 Grease Fittings, R303558 Bearings, & R305115 Seals:

Other Parts Available

All original equipment manufacturers names and part numbers are used for identification purposes only, and we are in no way implying that our products are original equipment parts. Prices subject to change without notice.



Replaces Jacobsen GP400 Parts

Cutting Unit
Rollers



Item No	R&R Part No.	OEM Part No.	Description	Qty Req	Order Quantity
30	R3001654	3001654	Shaft - Roller	1	
31	R253-152	3001656	Seal - Inner Roller	2	
32	R254-67	307108, 5000625, 500625	Cup - Bearing	2	
33	R254-68	307109, 5000625, 500625	Tapered Bearing Cone	2	
34	R337593	3000983, 337593	Seal	2	
35	R3001762	30001762, 3001762	Sleeve - Wear Hardened	2	
36	R3000698	3000698	Washer	2	
37	R445718	445718, 445801	Locknut - 5/8-18 All Metal	2	
38	R303558	303558	Bearing - Roller	2	
39	R305115	305115	Seal - Roller	2	
40	R302-5	302-5, 471214, 471223, 471226	Fitting - Grease	2	
41	R102030	102030	Shaft - Front Roller	1	
42	R154909	145909, 154909	Shaft - Rear Roller	1	
45	R012419	461357, 461359	Pin - Roll 1/8 x 3/4	2	
46	R102024	102024	Scraper - Solid Roller	1	
47	R303159	303159	Clip - Roller Scraper	2	
48	R407586	407586	Screw - 1/4-20 x 1/4 Pan HD	2	

All original equipment manufacturers names and part numbers are used for identification purposes only, and we are in no way implying that our products are original equipment parts. Prices subject to change without notice.



Replaces Jacobsen GP400 Parts

*Cutting Unit
Rollers*



Item No	R&R Part No.	OEM Part No.	Description	Qty Req	Order Quantity
49	R503378	503378	Bearing - with Cup	2	
50	R3296-15	3296-15, 367029, 444742	Locknut - 3/4-16 Nylon Jam	2	
51	R3010210	3010210	Seal - Roller	2	
52	R3009725	3009725	Shaft - Roller	2	
53	R101482	101482	Bearing - Rear Machined Roller	2	
54	R3000394	3000394	Tube - Aluminum Grooved Roller	1	

All original equipment manufacturers names and part numbers are used for identification purposes only, and we are in no way implying that our products are original equipment parts. Prices subject to change without notice.