



Replaces R&R Products Sand Max 216

Parts

Traction Unit

Traction Control Pedal

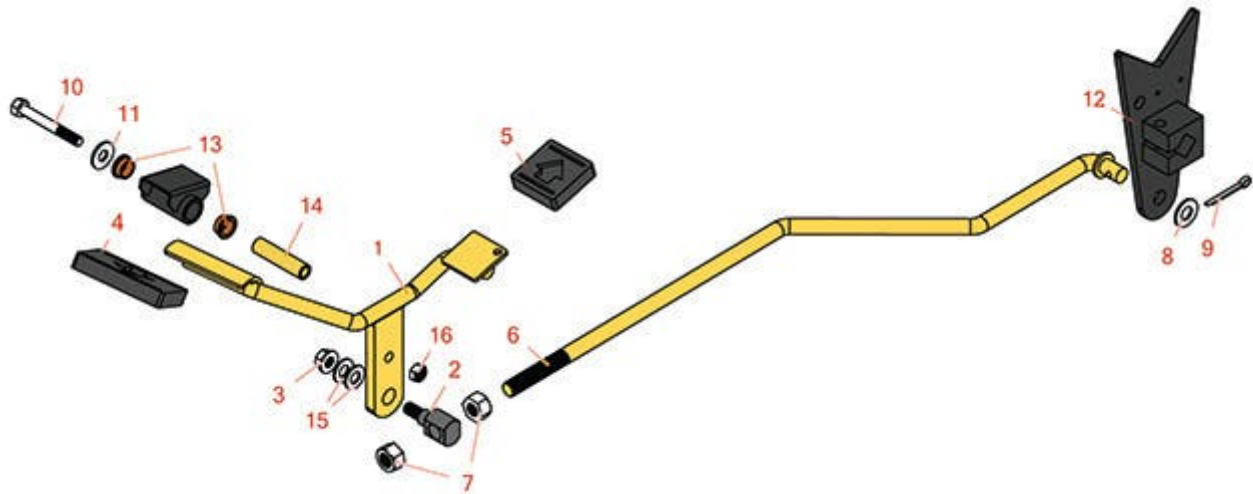

All original equipment manufacturers names and part numbers are used for identification purposes only, and we are in no way implying that our products are original equipment parts. Prices subject to change without notice.



Replaces R&R Products Sand Max 216

Parts

Traction Unit

Traction Control Pedal



| Item No | R&R Part No. | OEM Part No. | Description | Qty Req | Order Quantity |
|---------|--------------------|---|-------------------------------|---------|----------------|
| 1 | R92-2343-01 | R92-2343 | Pedal Assy | 1 | |
| 2 | R92-2344 | | Trunnion | 1 | |
| 3 | R3296-39 | 3296-39, R32127-25, R32128-36, R3296-17, R3296-22, R915663P, R99-7443 | Locknut - 3/8-16 Nylon | 1 | |
| 4 | R74-9100 | | Rubber Foot Pad - Forward | 1 | |
| 5 | R74-9110 | | Rubber Foot Pad - Reverse | 1 | |
| 6 | R95-0584 | | Rod-Control | 1 | |
| 7 | R443818 | R01-191-0813, R3218-18, R3218-5 | Nut - 1/2-13 Hex Jam Zinc | 2 | |
| 8 | R187-0 | 3256-25, R3256-25, R7-0032 | Washer - Flat 7/16 SAE | 1 | |
| 9 | R3272-16 | | Pin - Cotter 5/32 x 1-1/4 | 1 | |
| 10 | R322-14 | R01-150-0830, R01-178-0524, R30-8900 | Bolt - Hex HD 5/16-18 x 3 GR5 | 1 | |

All original equipment manufacturers names and part numbers are used for identification purposes only, and we are in no way implying that our products are original equipment parts. Prices subject to change without notice.



Replaces R&R Products Sand Max 216

Parts

Traction Unit

Traction Control Pedal



| Item No | R&R Part No. | OEM Part No. | Description | Qty Req | Order Quantity |
|---------|--------------|---|------------------------------|---------|----------------|
| 11 | R453009 | 3256-3, R01-166-0400, R24-10-BD, R24-9-AD, R24H1136, R32-9650, R3256-2, R3256-23, R3256-67, R3290-217, R3556-3, R4-2390, R452006, R7-0152 | Washer - Flat 5/16 SAE | 1 | |
| 12 | R112-0009 | R107-3515-03 | Lever - Pump Kit | 1 | |
| 13 | R256-156 | R256-219 | Bushing - Flanged | 2 | |
| 14 | R85-8960 | | Spacer | 1 | |
| 15 | R453011 | 3256-24, 453011, R01-166-0100, R01-166-0120, R01-166-0270, R01-166-0500, R01-166-0600, R01-166-0620, R132-4593, R237-12, R24-10-AD, R24-11-AD, R24-11-BD, R24-12-AD, R24-12-BD, R30-9310, R32-8190, R3256-24, R3256-3, R3256-36, R3256-4, R47-9950 | Washer - Flat 3/8 SAE Y/Zinc | 2 | |
| 16 | R3296-29 | 3296-29, R1-804256, R915662P | Locknut - 5/16-18 ESNA | 1 | |

All original equipment manufacturers names and part numbers are used for identification purposes only, and we are in no way implying that our products are original equipment parts. Prices subject to change without notice.



Replaces R&R Products Sand Max 216 Parts

Traction Unit

Traction Control Pedal



All original equipment manufacturers names and part numbers are used for identification purposes only, and we are in no way implying that our products are original equipment parts. Prices subject to change without notice.