

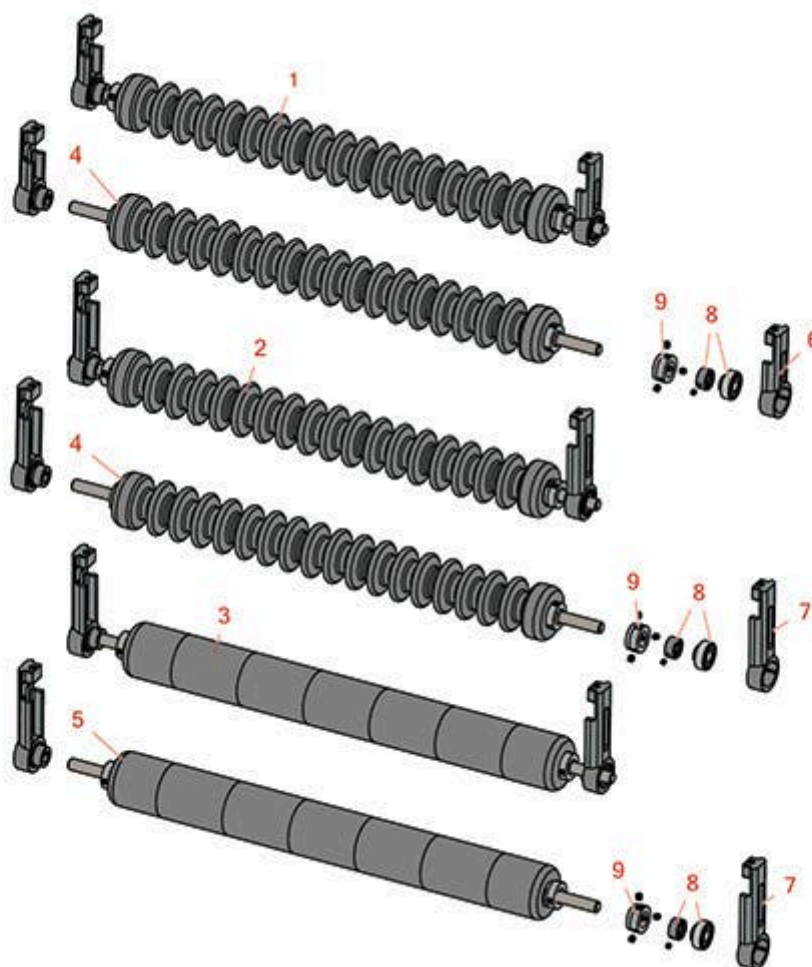

## Replaces Toro Reelmaster 2300D Parts

27in Cutting Unit - Models 03461 & 03462

Minuteman Roller System



All original equipment manufacturers names and part numbers are used for identification purposes only, and we are in no way implying that our products are original equipment parts. Prices subject to change without notice.



# Replaces Toro Reelmaster 2300D Parts

27in Cutting Unit - Models 03461 & 03462

Minuteman Roller System



Item No	R&R Part No.	OEM Part No.	Description	Qty Req	Order Quantity
---------	--------------	--------------	-------------	---------	----------------

## Complete Minuteman Roller Systems

1	<b>RMT2001</b>		Minuteman Front Grooved Roller System	0	
---	----------------	--	---------------------------------------	---	--

*Tech Note: 27" Units:*

*Detail Description: Complete roller systems include roller and two brackets with bearings.:*

2	<b>RMT2002</b>		Minuteman Rear Grooved Roller System	0	
---	----------------	--	--------------------------------------	---	--

*Tech Note: 27" Units:*

*Detail Description: Complete roller systems include roller and two brackets with bearings.:*

3	<b>RMT2003</b>		Minuteman Rear Smooth Roller System	0	
---	----------------	--	-------------------------------------	---	--

*Tech Note: 27" Units:*

*Detail Description: Complete roller systems include roller and two brackets with bearings.:*

## Minuteman Rollers Only

4	<b>RM524</b>		Minuteman Grooved Roller Only	0	
---	--------------	--	-------------------------------	---	--

*Tech Note: 27" Units:*

*Detail Description: Use with Minuteman Roller Bracket System Only:*

5	<b>RM525</b>		Minuteman Smooth Roller Only	0	
---	--------------	--	------------------------------	---	--

*Tech Note: 27" Units:*

*Detail Description: Use with Minuteman Roller Bracket System Only:*

## Other Parts Available

6	<b>RT221</b>		Bracket - Front RH/LH	0	
---	--------------	--	-----------------------	---	--

7	<b>RT231</b>		Bracket - Rear RH/LH	0	
---	--------------	--	----------------------	---	--

8	<b>RMMB157</b>		Bearing w/Locking Collar	0	
---	----------------	--	--------------------------	---	--

9	<b>RMM3</b>		End Hub - 7/8 ID	0	
---	-------------	--	------------------	---	--

All original equipment manufacturers names and part numbers are used for identification purposes only, and we are in no way implying that our products are original equipment parts. Prices subject to change without notice.